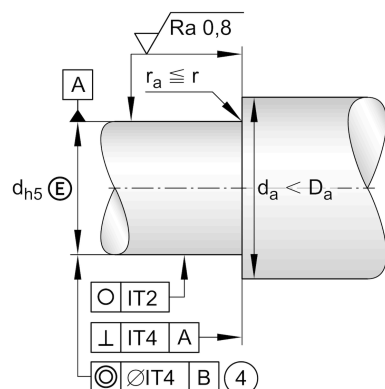
**ZARN60120-L-TV**

Axial/radial bearing

Schaeffler ID:
0016833060000

Needle roller/axial cylindrical roller bearings ZARN..-L, double direction, long shaft locating washer

Technical information

**Main Dimensions & Performance Data**

d	60 mm	Bore diameter
D	120 mm	Outside diameter
H	103 mm	Height
C _a	187,000 N	Basic dynamic load rating, axial
C _{0a}	550,000 N	Basic static load rating, axial
C _r	44,500 N	Basic dynamic load rating, radial
C _{0r}	92,000 N	Basic static load rating, radial
C _{ua}	51,000 N	Fatigue load limit, axial
C _{ur}	12,900 N	Fatigue load limit, radial
n _{G Oil}	2,700 1/min	Limiting speed for oil lubrication
n _{G Grease}	950 1/min	Limiting speed for grease lubrication
M _{RL}	4.2 Nm	Bearing friction torque
	4.39 kg	Weight

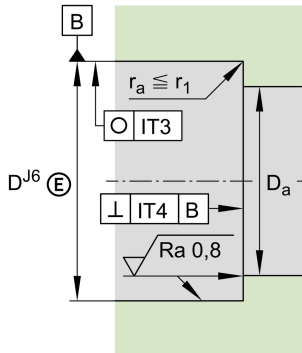
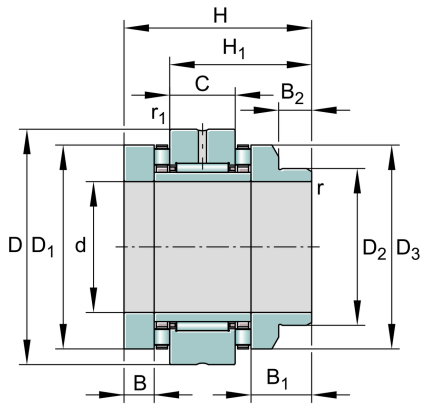

Dimensions

H_1	74.5 mm	Height outer ring over wave washer
c_{aL}	5,300 N/ μm	Rigidity axial
c_{kL}	4,300 Nm/mrad	Tilting stiffness
C	25 mm	Width, outer ring
M_m	54.5 kg * cm^2	Mass moment of inertia
	1 μm	Axial runout
D_1	105 mm	Rip diameter shaft washer
D_2	90 mm	Heeldiameter wave washer long
radial	ZMA60/98	Locknut 1
axial	AM60	Locknut 2
D_3	105 mm	Outside diameter wave washer long
M_A	250 Nm	Tightening torque nut
B	17.5 mm	Width, inner ring
	41,144 N	Preload force axial
B_1	38.5 mm	Width wave washer long
	90X110X12	Sealing ring
B_2	18 mm	Width heel wave washer long
r_{min}	0.3 mm	Minimum chamfer dimension
$r_{1 \text{ min}}$	0.6 mm	Minimum chamfer dimension

Mounting dimensions

$D_{a \text{ max}}$	106 mm	Maximum diameter of housing shoulder
$d_{a \text{ min}}$	88 mm	Minimum diameter shaft shoulder